

Following tradition, formal rooms are at the front of this two-story contemporary Craftsman cottage. But in this update, the heart of the home is a generously sized family room, open to the kitchen and eating nook. A raised eating/conversation bar also serves to hide kitchen clutter.

The luxurious owners' suite is on the main floor. For more details, log onto www.Home-Plan-Weekly.com, or call 1-800-634-0123.

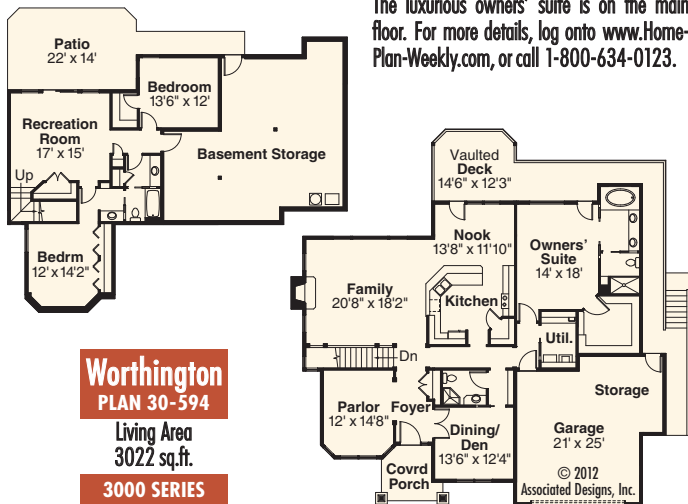

Worthington
PLAN 30-594

Living Area
3022 sq.ft.

3000 SERIES